

Cycling Controllable Property (Apple)

Step 1: In the menu bar tap on TOOLS

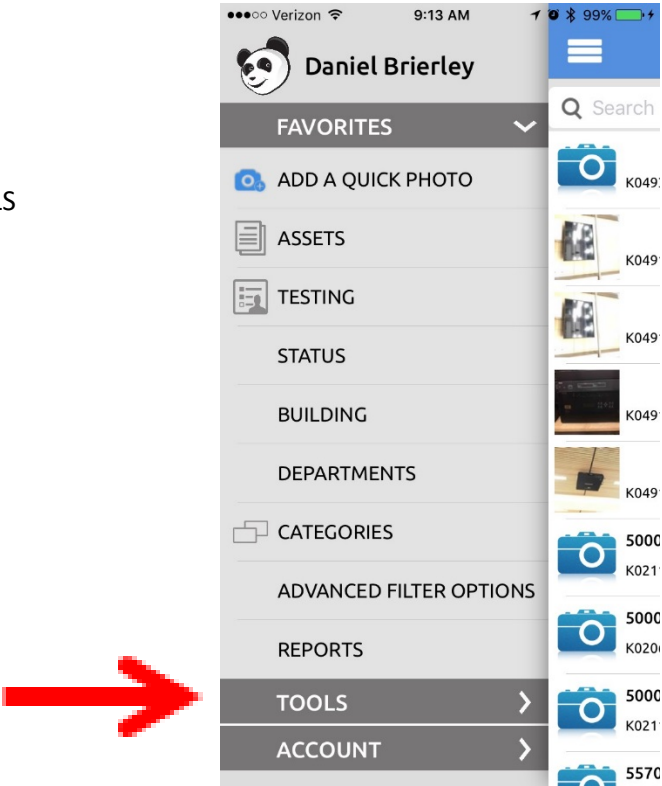

Step 2: Tap on GROUP SCAN

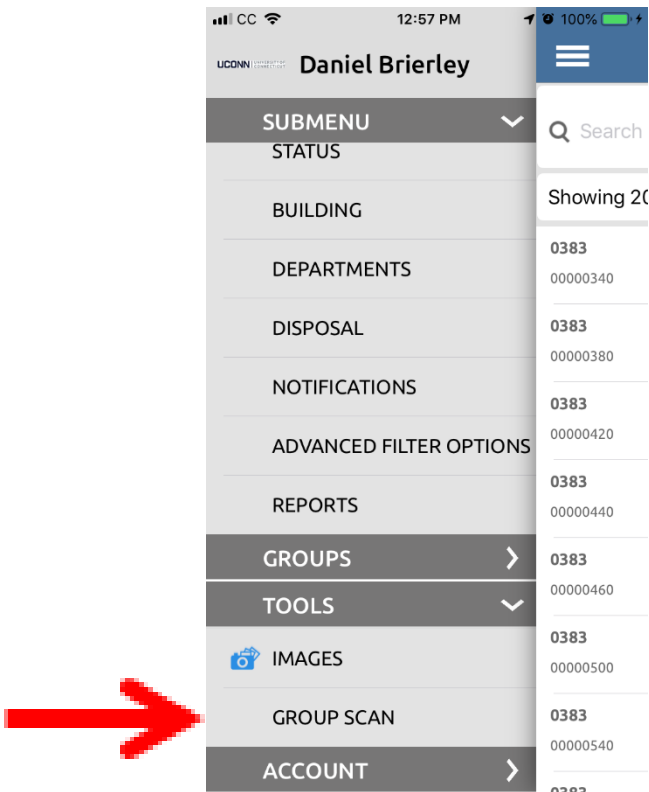

Cycling Controllable Property (Apple)

Step 3: Tap on the space next to Group Scan.

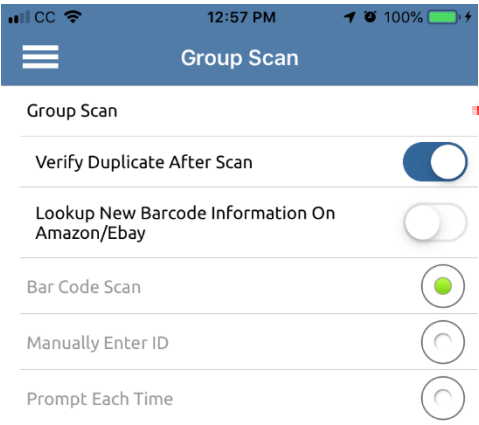

Step 4: Tap on the Assets checkbox.

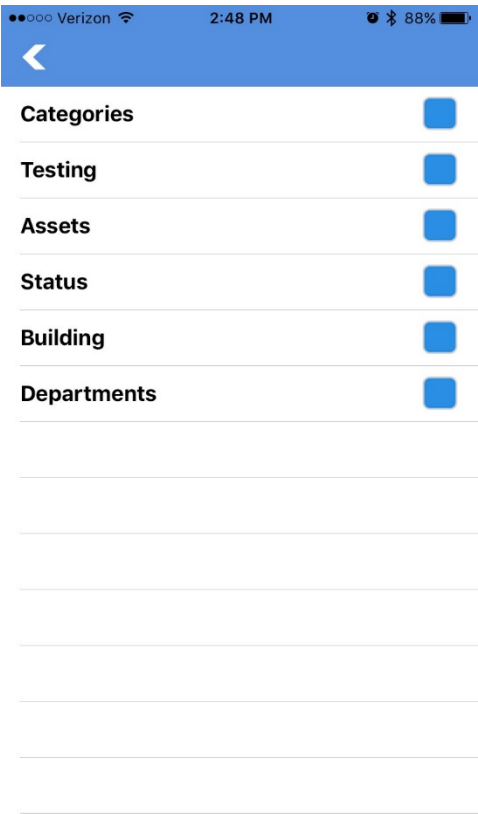

Cycling Controllable Property (Apple)

Step 5: Assets appears on Group Scan

Verify Duplicate After Scan (should be checked)

Tap on **Prompt Each Time**

Tap on the check mark

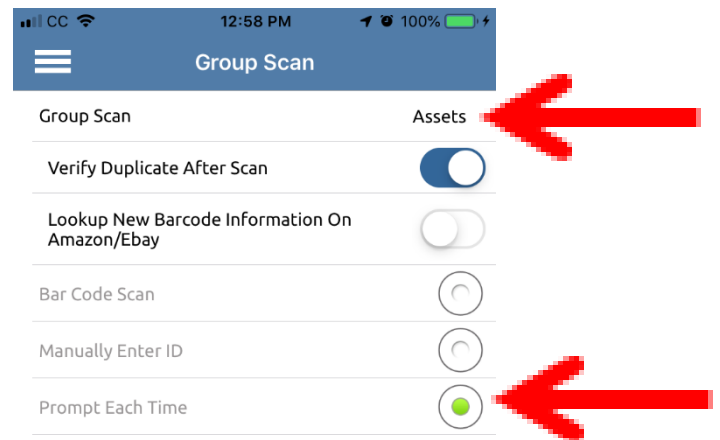

Step 6: Tap on Scan Barcode

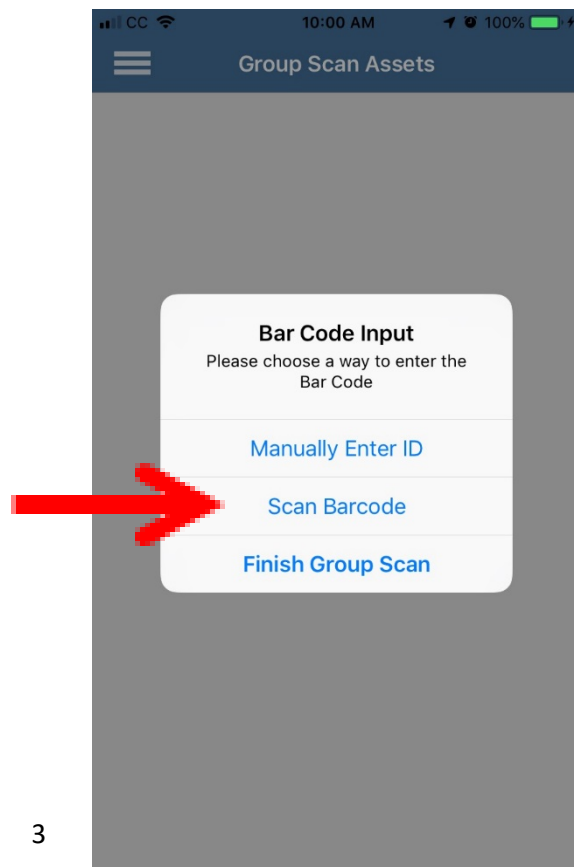

Cycling Controllable Property (Apple)

Step 7: The barcode scanner will pop up and
You can now scan your asset.

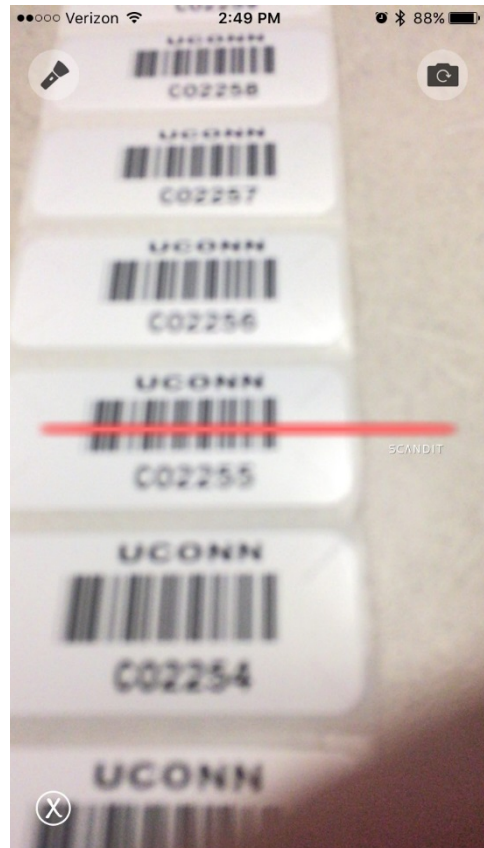

Step 8: After scanning the Bar Code Input screen
will reappear.

Tap either Finish Group Scan or Scan Barcode
Scan Barcode will allow you to add more records to
the group for the same location.

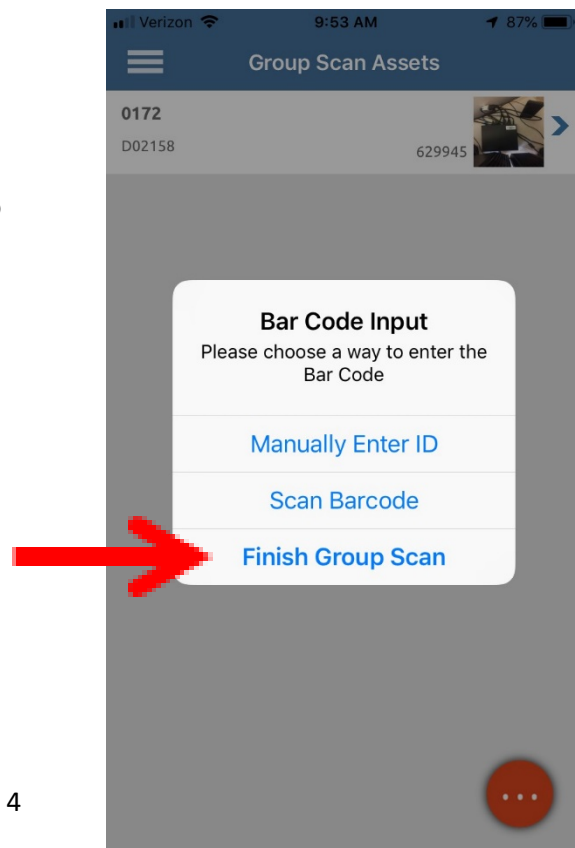

Cycling Controllable Property (Apple)

Step 9: Tap on the red circle with three white dots

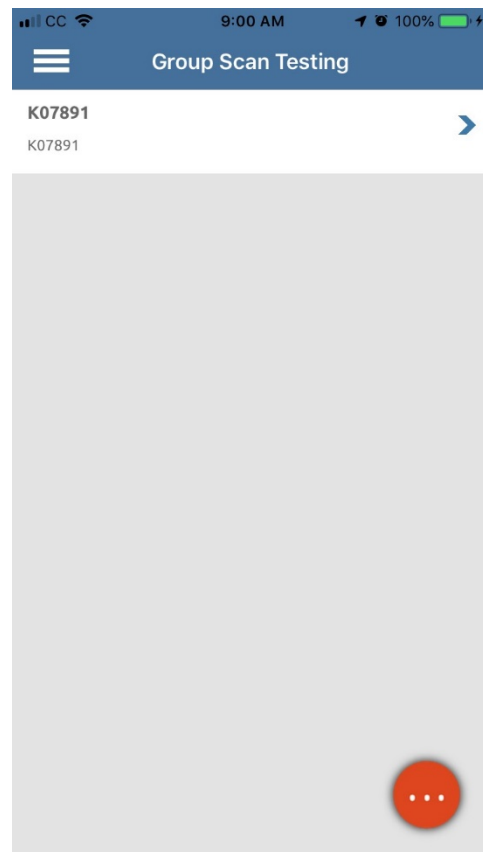

Step 10: Tap on Apply Group Actions

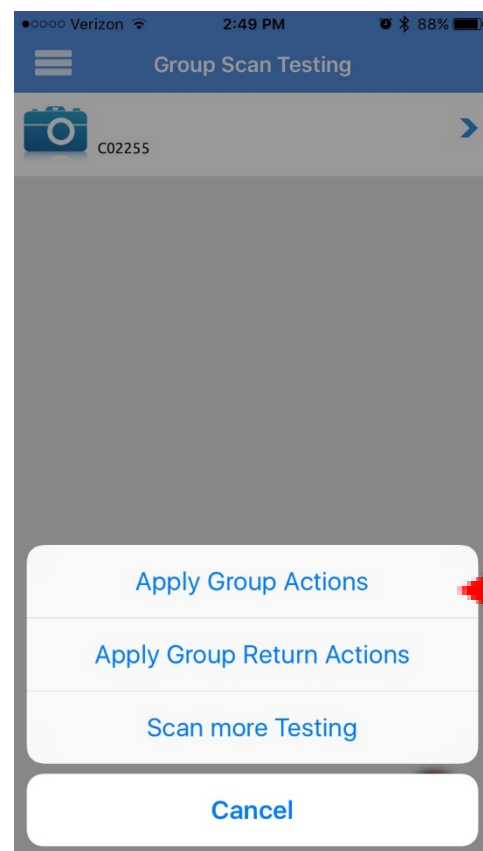

Cycling Controllable Property (Apple)

Step 11: Tap on DEPT AUDIT

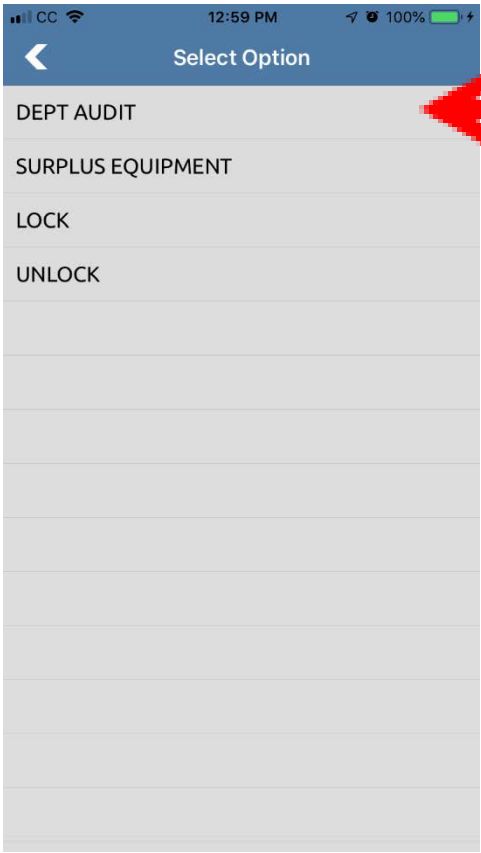

Step 12: Fill out all required fields marked with a *
Then tap on Save.

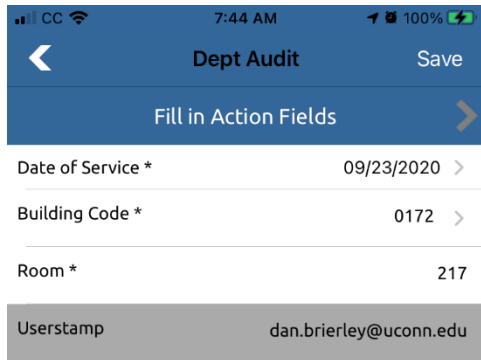

Cycling Controllable Property (Apple)

Step 13: After creating the “Group Action” you can either:

1. Start a new group scan by tapping on Scan new items
- OR
2. You can minimize the app and swipe up to exit.

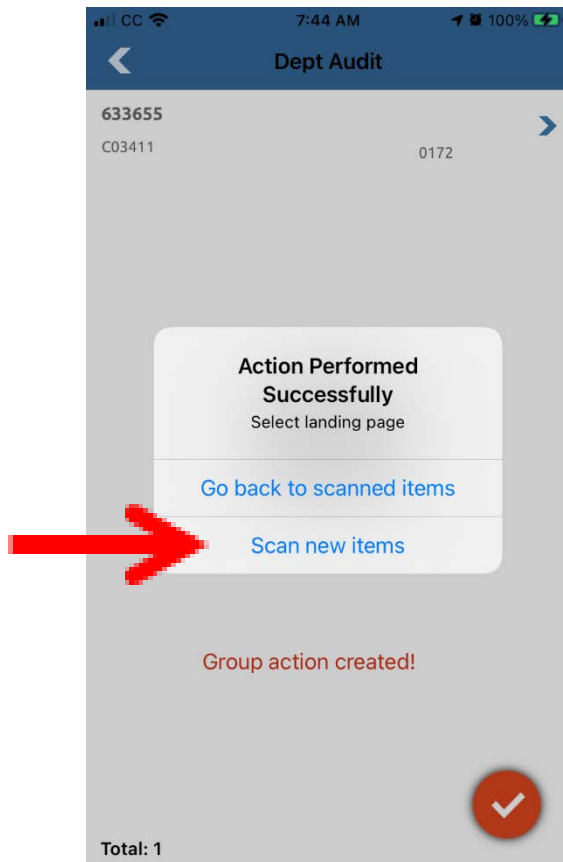

OR

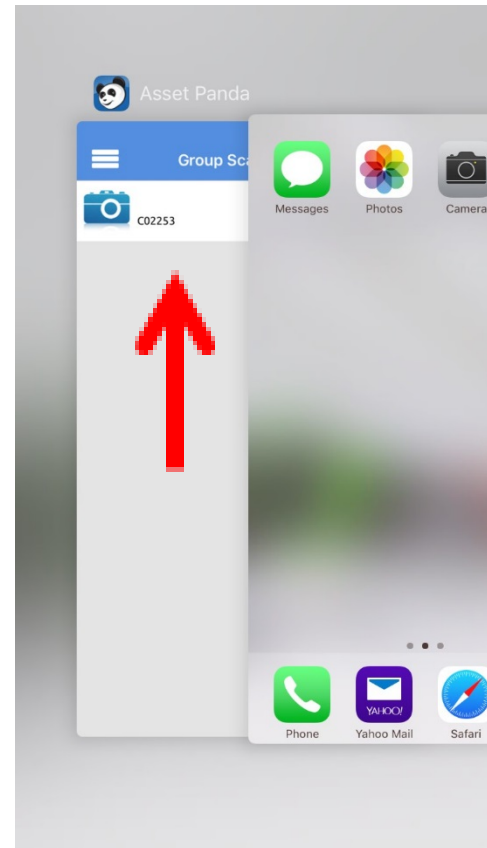

Shortly after completing a Group Scan you will receive an email from Asset Panda indicating the equipment you have updated.

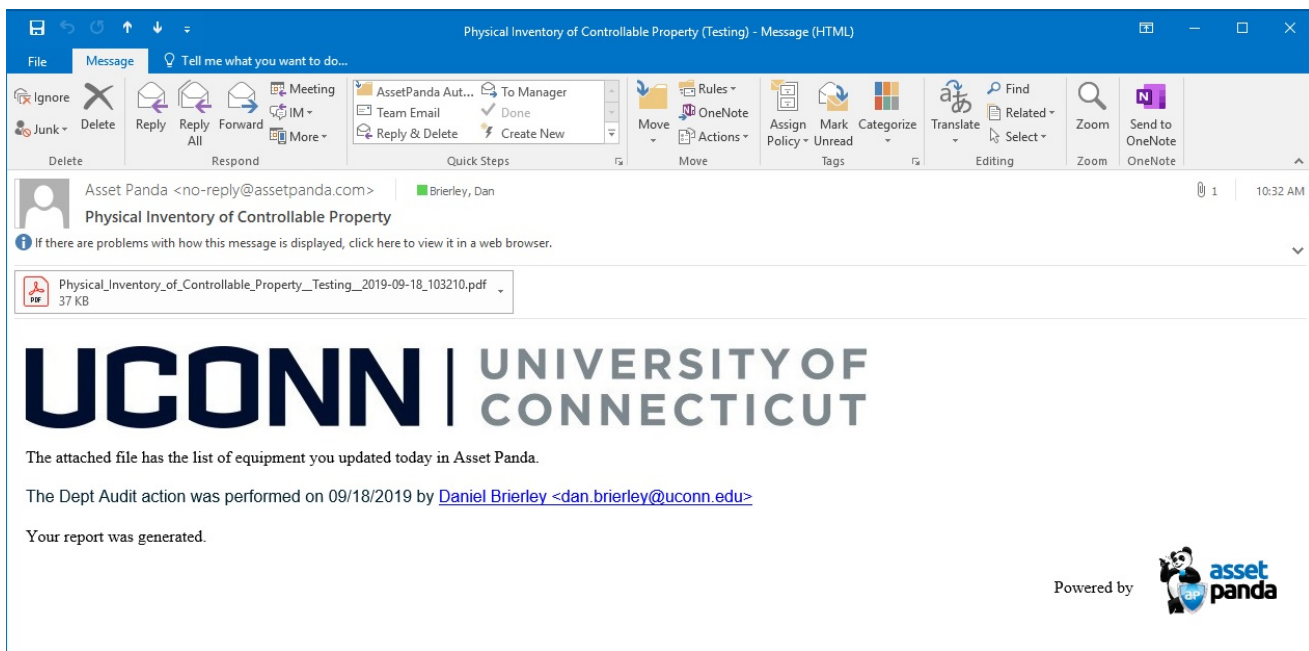

Cycling Controllable Property (Apple)

What Happens When you Lose Wi-Fi ?(IPad)

When Wi-Fi Connection is lost you will receive the following screen. When the connection is re-established your progress will resume exactly where you left off. No data will be lost.

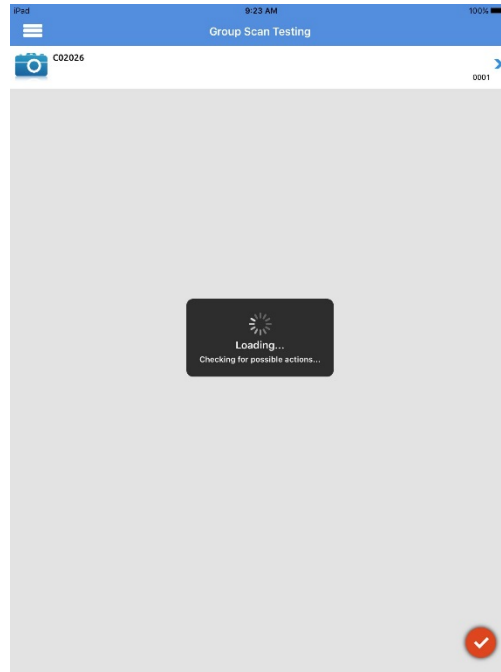

If Wi-Fi signal is lost during the updating of an individual asset you will get a spinning wheel when you go to press the red check box. Once the Signal is re-established the record will be updated but the asset will need to be re-scanned to be included in the group scan process.

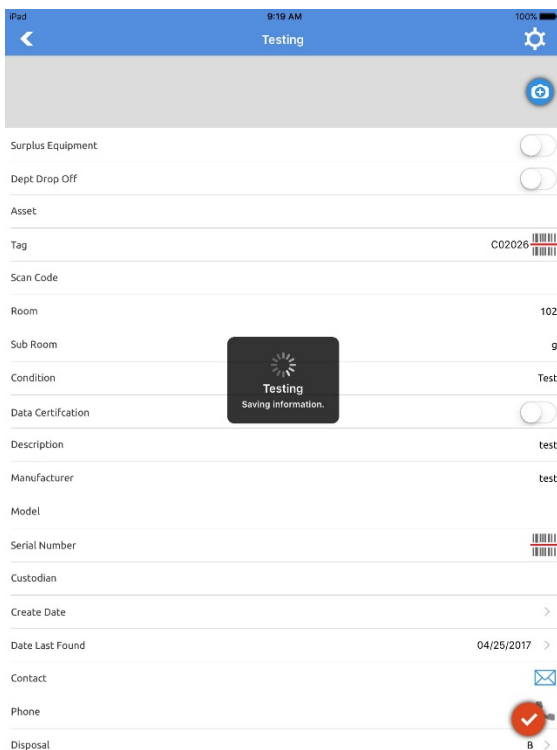

=

8

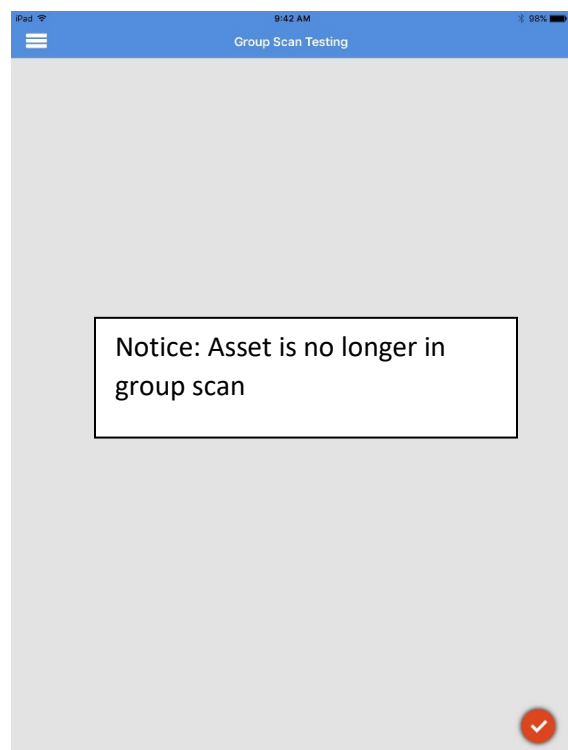

Cycling Controllable Property (Apple)

What Happens When you Lose Wi-Fi? (iPhone w/Cellular)

When Wi-Fi Connection is lost you will receive the following screen and an error message saying a data connection has been lost. At this point the app will continue using cellular data if enabled until a Wi-Fi signal is re-established. Your progress will resume exactly where you left off. No data will be lost.

