

# How To Surplus Equipment (Android)

Surplus will use the information submitted via Asset Panda to contact the department to schedule the pick-up of assets. Lead-time is 5 to 10 business days. Material that Surplus will not accept includes, but is not limited to, construction debris, light bulbs, household trash, and lab glass. For Freon and oil removal from refrigeration units and motors, a work order must be placed with Facilities Operations prior to Surplus picking up those items. A step-by-step process is listed at [www.stores.uconn.edu/surplus.html](http://www.stores.uconn.edu/surplus.html).

Step 1: In the menu bar tap on TOOLS

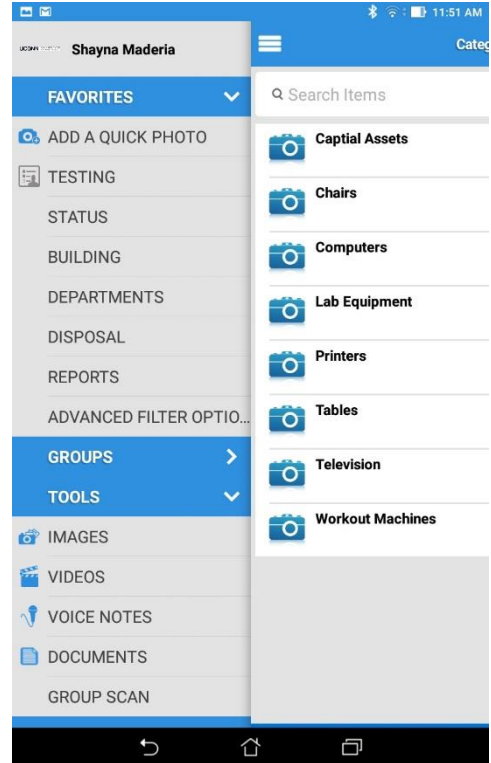

Step 2: Tap on GROUP SCAN

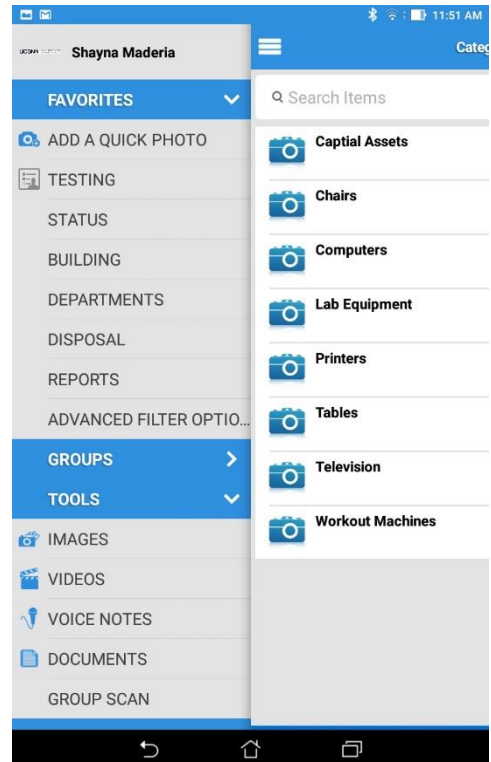

# How To Surplus Equipment (Android)

Step 3: Tap on click to select group

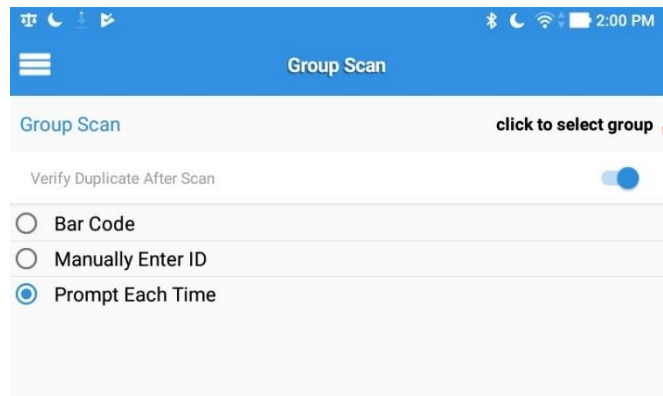

Step 4: Tap on Assets

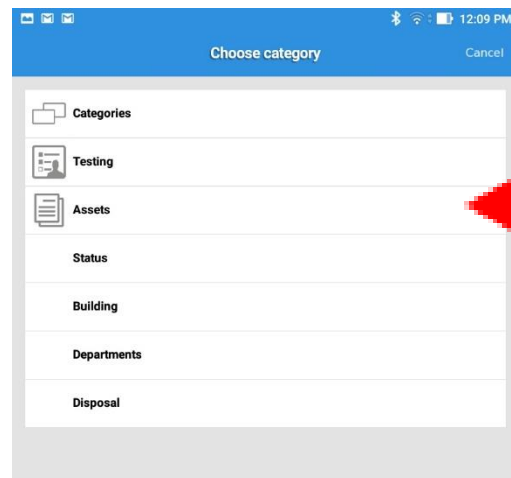

Step 5: Assets appears on Group Scan

Verify Duplicate After Scan (should be checked)

Prompt Each Time (should be checked)

Tap on the check mark

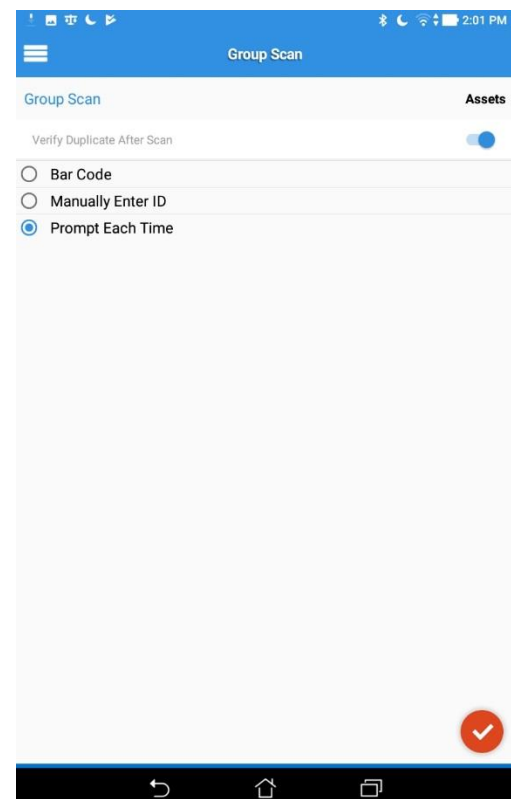

# How To Surplus Equipment (Android)

Step 6: Tap on Scan Barcode

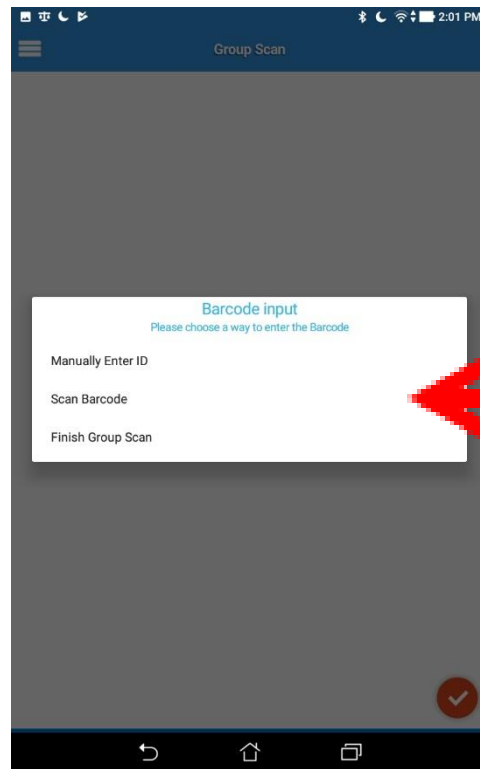

Step 7: The barcode scanner will pop up and you can now scan your asset.



# How To Surplus Equipment (Android)

Step 8: After scanning a pop up message will appear.

Tap either:

ADD NEW ITEM (This will be to add the scanned item into AssetPanda so that it can be marked as Surplus)  
(Go to step 9)

OR

SCAN NEW(This will allow you to add more records to the group for the same location.)(Go to step 6)

OR

FINISH SCAN (This is to continue along in the Surplus Process)(Go to step 14)

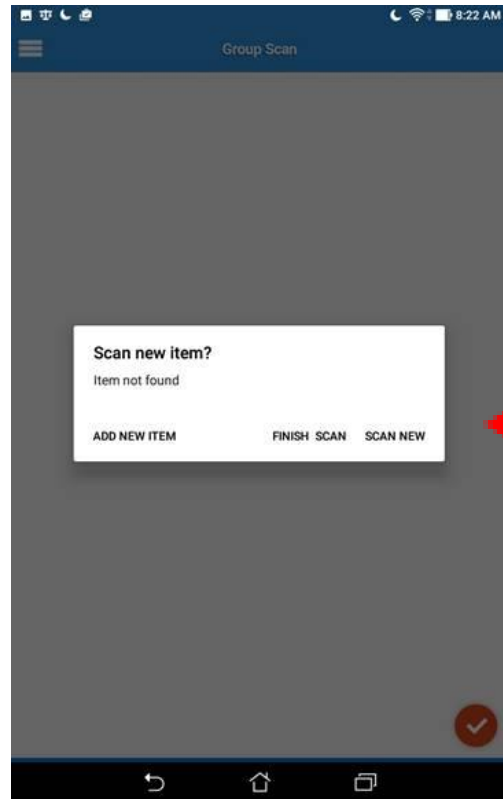

Step 9: Tap on Take a Photo.

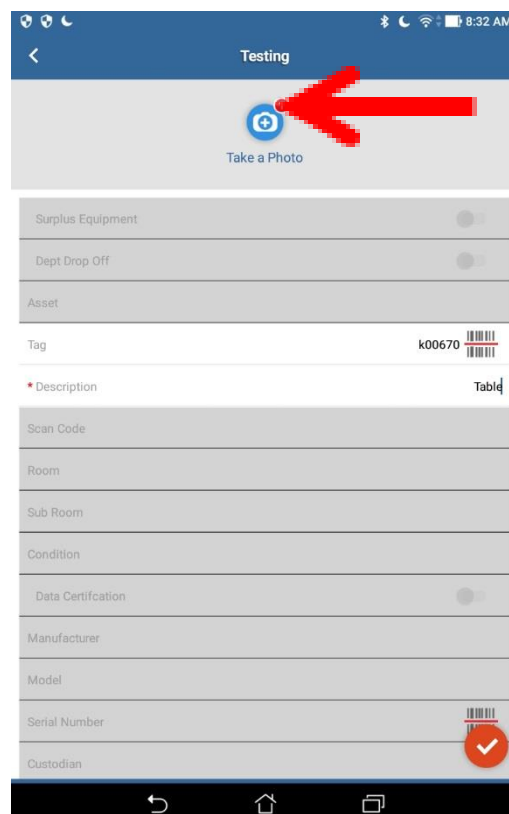

# How To Surplus Equipment (Android)

Step 10: Tap on Take Photo.

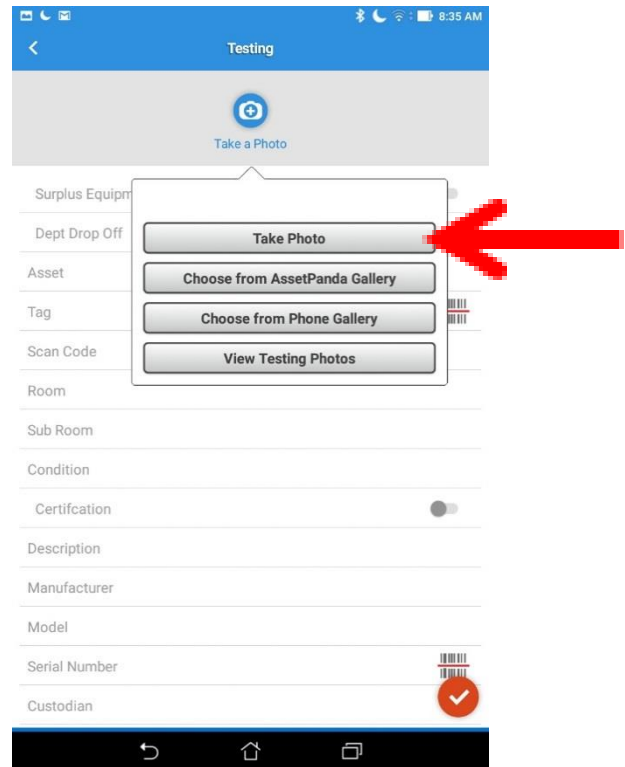

Step 11: Take Photo, then tap on the check mark.

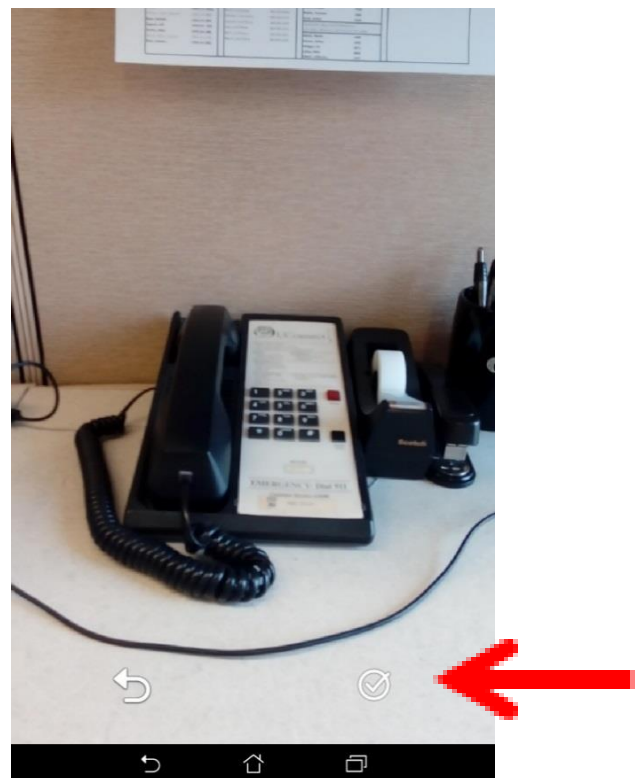

# How To Surplus Equipment (Android)

Step 12: A 1 will appear in the top right of the “Take a Photo” icon. This is to let you know the photo has been attached

Type in the description of the item, then Tap on the check mark

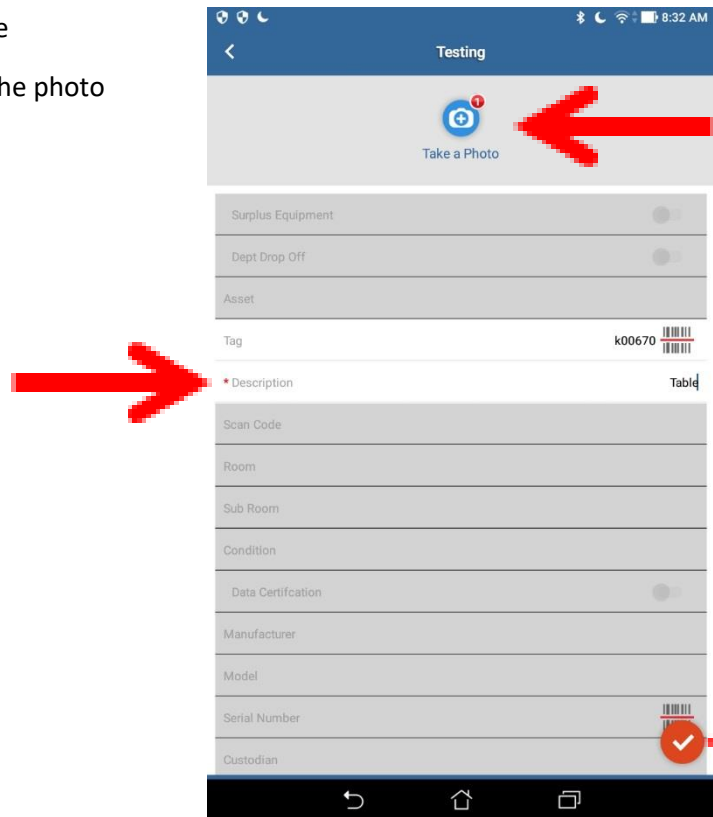

Step 13: Tap either:

Scan Barcode (return to step 6)

OR

Finish Group Scan (Go to step 14)

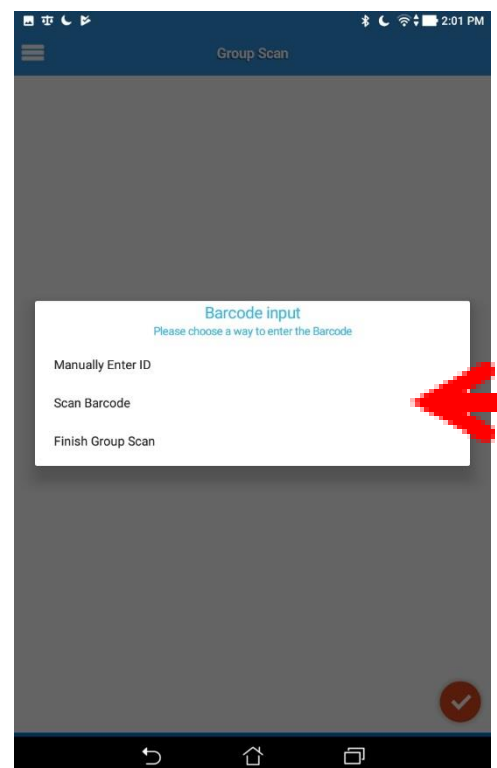

# How To Surplus Equipment (Android)

Step 14: Tap on Apply Group Actions

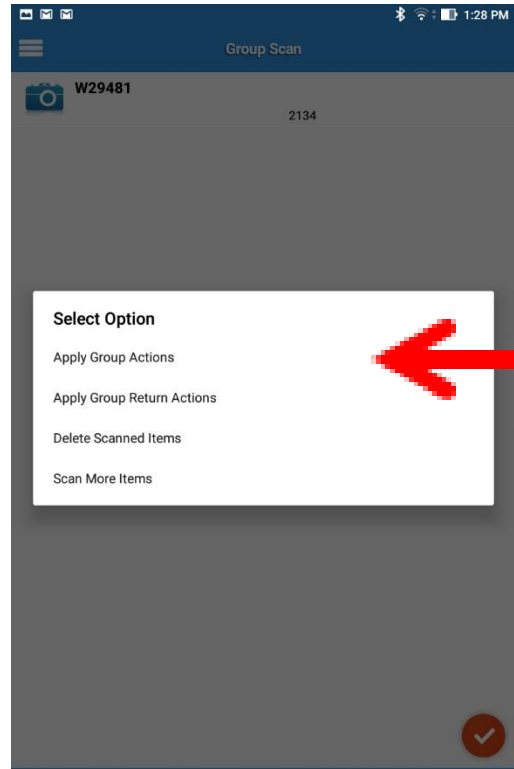

Step 15: Tap on the Setting Wheel

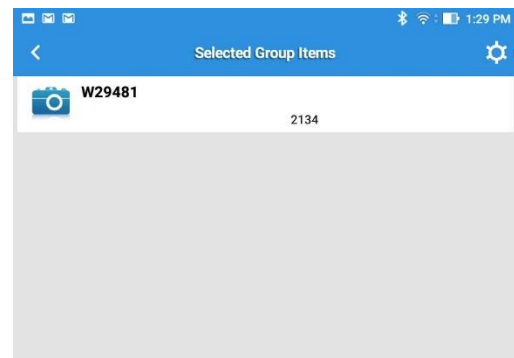

# How To Surplus Equipment (Android)

Step 16: Tap on Surplus Equipment

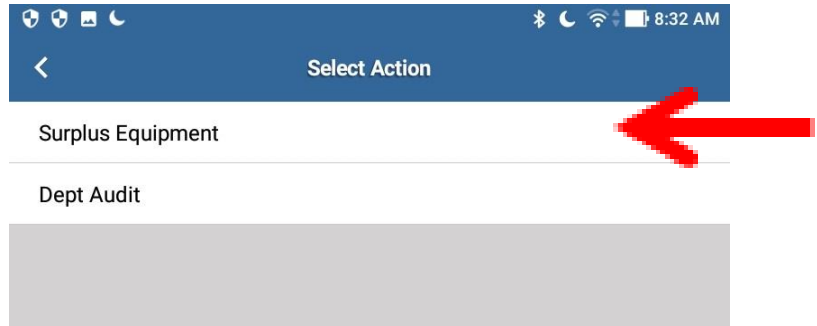

Step 17: Fill out all required fields marked with a \*

Date of Service – defaults to today's date

Tap OK and date field will be populated.

Surplus Equipment – autofilled to “Yes”

\*Contact – enter your Uconn email address

\* Phone – enter full phone number (extensions will not work)

\*Building Code – you can search by entering the

building name to find the building code. Tap on the building and building code field will be populated.

\*Room Number

\*Data Certification – A Data Certification Form

MUST be completed for all computers/electronic media going to Surplus (<http://stores.uconn.edu/surplus.html#computers>).

Tap here to indicate completion of the form verifying that all data has been permanently removed from the hard drive.

Form must accompany asset to Surplus.

\*Dept Delivered – Tap here to indicate that the asset will be delivered to Surplus by the department (no pick-up required)

Tap Save when done

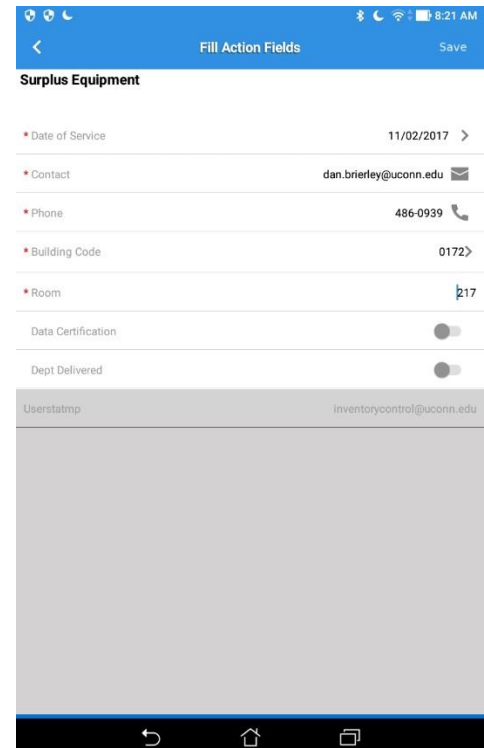
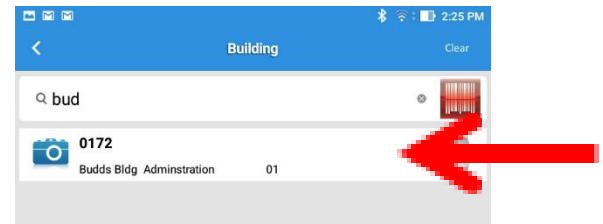



# How To Surplus Equipment (Android)

Step 18:

After creating the “Group Action” you can either:

1. Tap on the three white bars to return to main menu  
Then tap ASSETS to reset the application  
Then return to Step 1 to scan assets with a new location  
OR
2. You can minimize the app and tap on the X to exit.

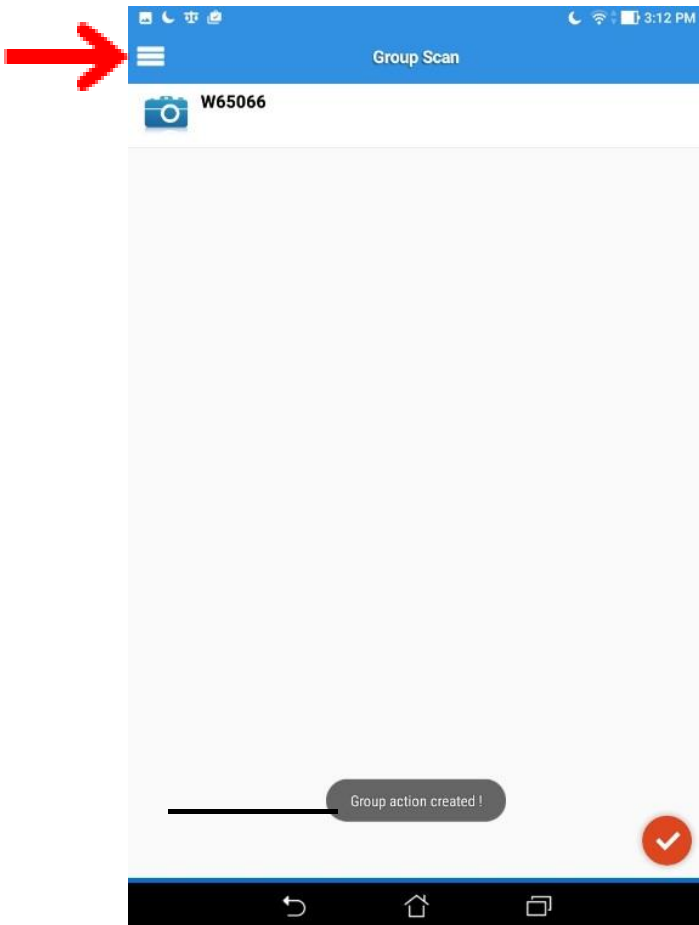

OR

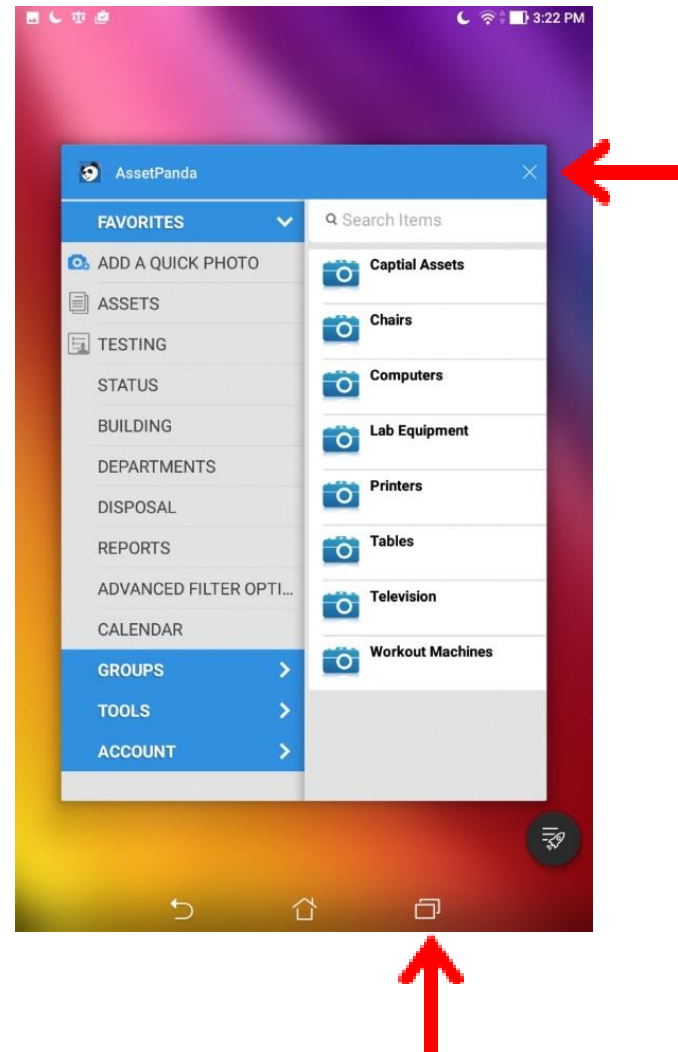

## How To Surplus Equipment (Android)

# What Happens When you Lose Wi-Fi?

When Wi-Fi Connection is lost you will receive the following screen. When the connection is re-established your progress will resume exactly where you left off. No data will be lost.

